

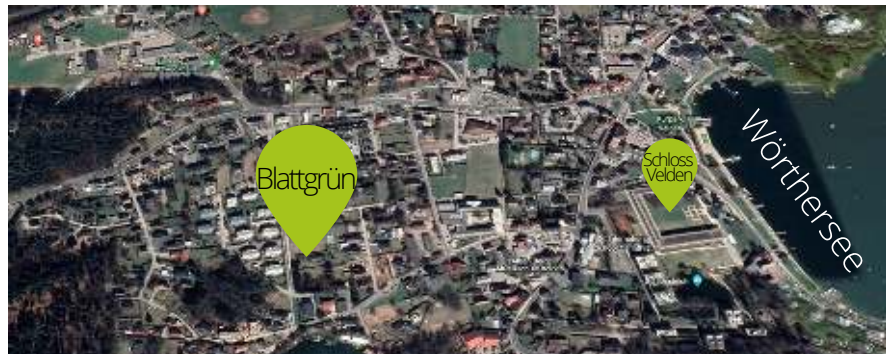

BLATTGRÜN WOHNANLAGE VELDEN TOP 2 | HAUS A | EG

| | |
|-------------|----------------------|
| Wohnfläche: | 53,60 m ² |
| Zimmer: | 2 |
| Terrasse: | 17,16 m ² |
| Garten: | 31,33 m ² |

€ 485.000,-

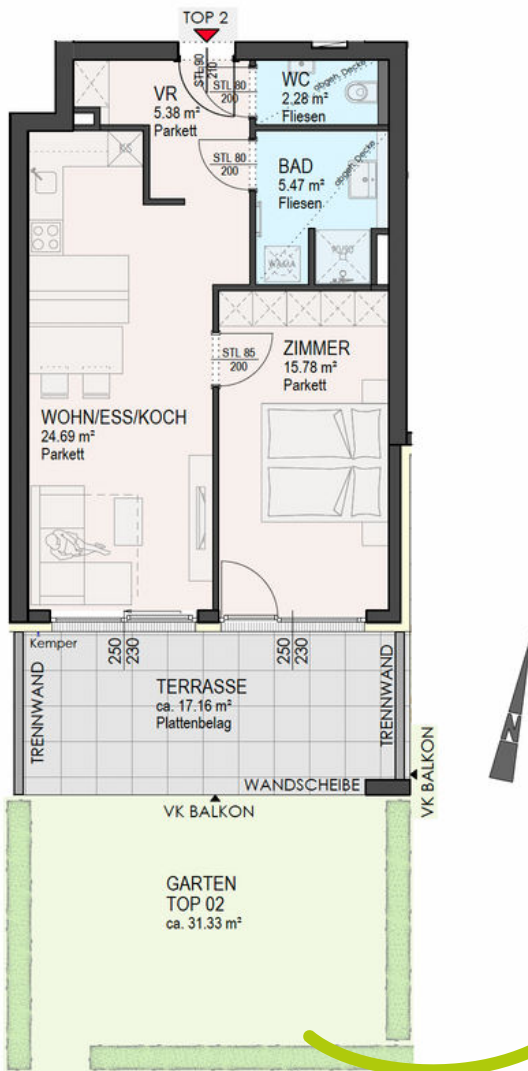

MARTIN-LUTHER-STRASSE, 9220 VELDEN AM WÖRTHERSEE

ALL IN ONE IMMOBILIEN ☎ 0664/92 90 490 ✉ HPW@ALLINONE.IMMO